



22 Taminga Avenue Glenunga SA

3 2 2

Situated in one of the most sought-after and exclusive streets in Glenunga this wonderful home offers exceptional modern living with an abundance of features throughout. Remote-controlled steel driveway gates open to reveal the low maintenance gardens which surround this unique contemporary exterior in this peaceful blue-chip location.

Set over one level with wide and easy access throughout, the cleverly placed windows to the north allow sunshine to flood the living space and bounce off the lofty ceilings.

The beautifully crafted kitchen overlooks the dining and living area which opens up to the fully covered outdoor entertaining space and low maintenance garden.

[For full version visit the website](#)

Type : House
Land Size : 719 sqm
View : <https://www.alexanderrealestate.com.au/sale/sa/eastern-suburbs/glenunga/residential/house/7260109>



Steve Alexander
0411 755 985

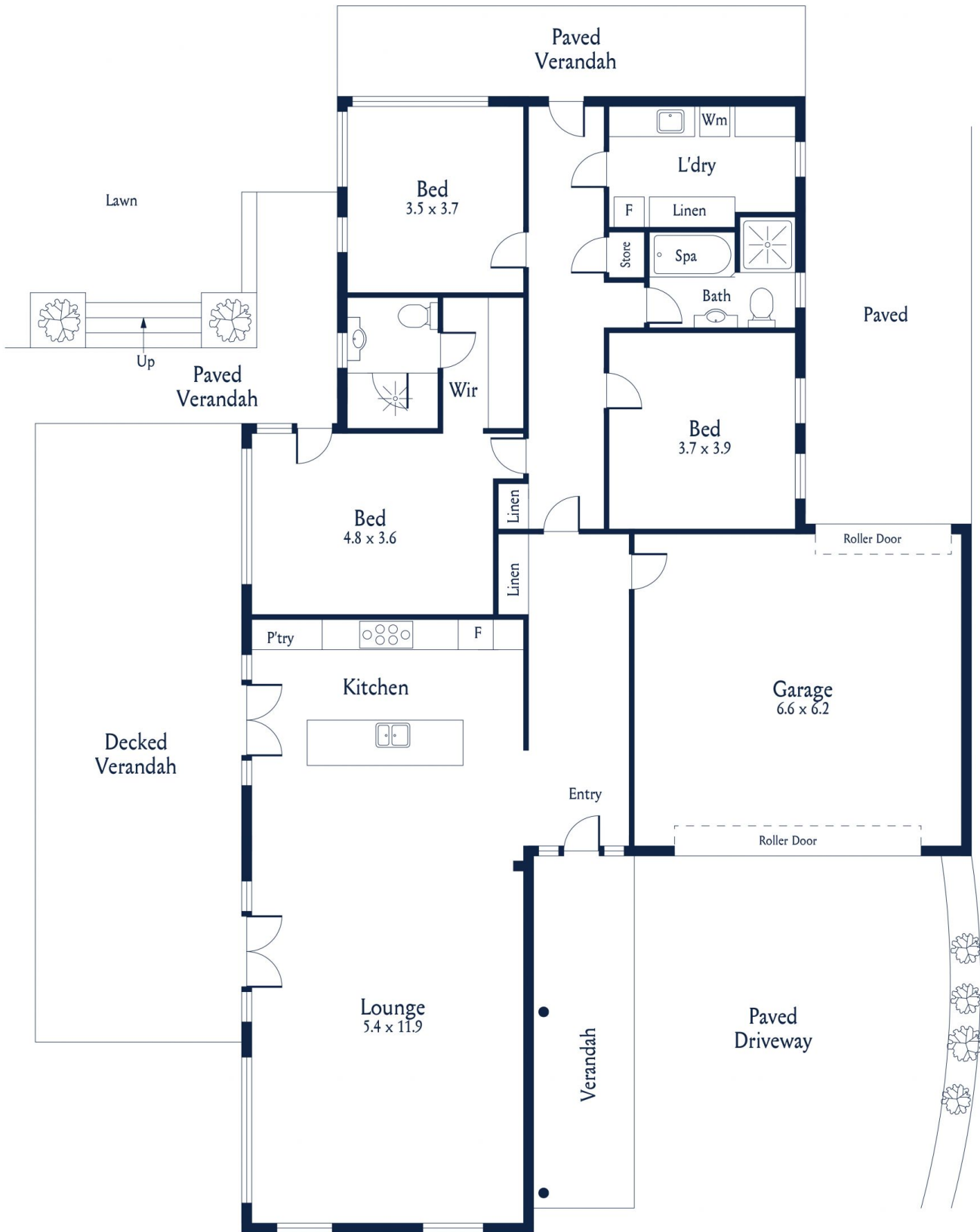

22 Taminga Avenue, Glenunga

Internal - 221.4 SQM
 External - 81.1 SQM
 Total - 302.5 SQM