



7 Lanark Street Rosslyn Park SA

5 🛏 2 🚿 2 🚗

An outstanding opportunity to secure this stunning property to enjoy as is or look to the future to rebuild your dream masterpiece. The potential of this unique land holding is only limited by your imagination.

The lovely family home offers polished timber floors, plantation shutters, modern bathroom and kitchen plus a large undercover deck with pitched roof overlooking the tennis court and pool.

An enviable northerly aspect and rare land size is a combination that's hard to find!

Located in the heart of Rosslyn Park with easy access to local Erindale and Wattle Park shopping centres, Kensington Gardens Reserve and quality private and public schooling close by.

Land Size : 1458 sqm

View : <https://www.alexanderrealestate.com.au/sale/sa/eastern-suburbs/rosslyn-park/residential/house/7260110>

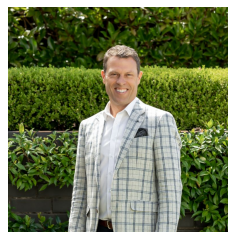

Steve Alexander
0411 755 985



7 Lanark Street, Rosslyn Park

	Internal	- 189.7 SQM
	External	- 100.2 SQM
	Total	- 289.9 SQM

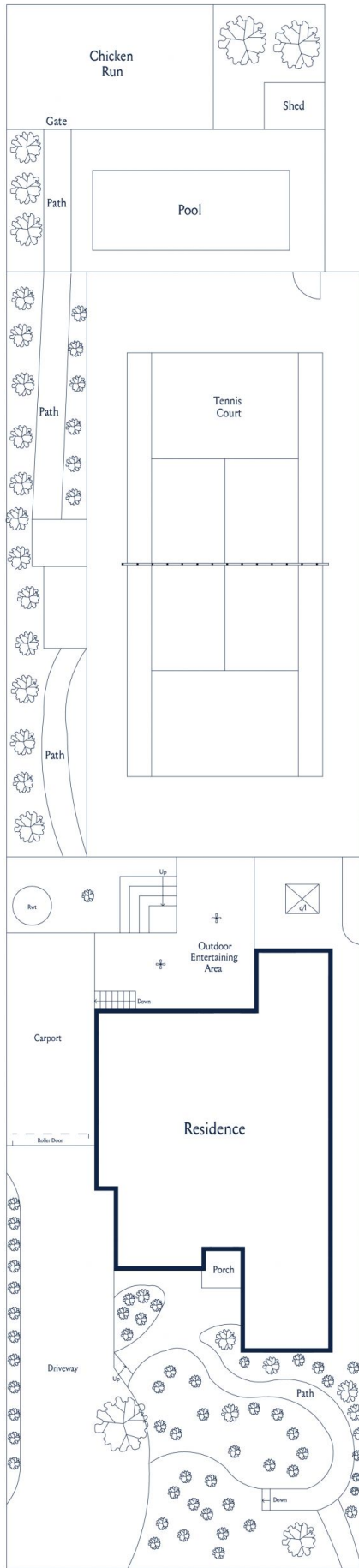

7 Lanark Street, Rosslyn Park

